



Ikaze Kuri Kigali

(Welcome to Kigali)

This document contains some basic information to help you plan your trip.

Table of Contents

- At a Glance.....Page 1
- Travel Agent Page 2
- Airlines..... Page 2
- Visa InformationPage 2
- Vaccinations.....Page 3
- Connectivity.....Page 3
- Money.....Page 4
- Plastic Ban.....Page 4
- Health & Medical Insurance.....Page 4
- ElectricalPage 4
- Weather.....Page 5
- What to Wear.....Page 5
- Getting AroundPage 6

At a Glance

Known as the land of a thousand hills, Rwanda is ranked as the second easiest place to do business in Africa by the World Bank and has been awarded for its leadership in economic competitiveness and tourism by the World Economic Forum and the World Travel and Tourism Council (WTTC), respectively.

Rwanda's beautiful landscape and warm, friendly people offer unique experiences in one of the most remarkable countries in the world. It is blessed with extraordinary biodiversity, with incredible wildlife living throughout its volcanoes, montane rainforest and sweeping plains. Travelers come from far and wide to catch a glimpse of the magnificent gorillas, yet there is so much more to see and experience.

Rwanda operates on Central African Time. The official languages in Rwanda are Kinyarwanda, French and English and the currency is Rwandan Franc although payment cards and US Dollars are accepted (US\$ especially for larger value purchases). The country's population is 13 million.

Time Zone	Official Languages	Currency	Population
Central Africa Time (GMT/UTC + 2 hours)	Kinyarwanda French English	Rwandan Franc (Rwf)	13 Million

Travel Agent

The event travel agent is Xpedia Travel Management Ltd. Please contact them for assistance with your travel arrangements, including travel insurance:

Xpedia Travel
Willowdale 3rd floor, Rhapta Road
P.O Box 12911 – 00400 Nairobi, Kenya
Office Tel: +254 020 3740993
Email: info@xpeditravel.co.ke
Website: www.xpeditravel.co.ke

Contacts: James Kinyua, james@xpeditravel.co.ke and Lilian Ngunyi, lilian@xpeditravel.co.ke

Airlines

Airlines servicing Kigali International Airport are:

- RwandAir – Attendees benefit from a 10 percent discount
- Ethiopian Airlines
- Kenya Airways
- Brussels Airlines
- KLM
- Qatar Airways
- Turkish Airlines

Visa Information

Rwanda offers a Visa on Arrival service or a pre-application. The visa fees are approximately 50 USD for single entry visa or 70 USD for multiple entry. Certain countries are granted a free visa (see below). There is no single affiliated agent that is authorized to apply for a visa on your behalf.

Applying for a Rwanda Visa Online (e-Visa)

You can apply for an e-visa if you want to apply for a Rwanda visa in advance. With an e-visa you can stay in Rwanda for as long as 90 days.

You will need to log on to Irembo, an online portal where you can access government public services, including visa and permit applications from the immigration department. Once you've registered on the visa application:

- Click on either “Apply and Pay Online” or “Apply and Pay On Arrival”.
- Input your identifying information.
- Enter your trip information, including travel dates, information on where you will be staying, and your proposed entry point. You are also required to provide details about the purpose of visiting Rwanda.
- Upload a copy of your passport, photo, invitation letter (details of your trip), and supporting documents. Confirmation will be emailed to you via the system.

Applying for a Rwanda Visa on Arrival (VoA)

You can apply for a visa on arrival at land borders and Kigali International Airport. This option is available to citizens of every country. The visas you can apply for upon arrival include tourism visa, transit visa, and East Africa Tourist Visa. The Rwanda VoA is only valid for up to 30 days.

Please note you may have to queue in long lines at the airport, therefore, and the entire process can be slow.

Citizens of country members to the African Union, Commonwealth and La Francophonie can get free visas upon arrival in Rwanda for a visit of 30 days. A citizen of East African Community Member States can receive a pass/entry visa free of charge upon arrival for a six-month stay in Rwanda.

Visitors from the following countries can be granted 90-day visas at no cost upon arrival in Rwanda: Angola, Benin, Central African Republic, Chad, Cote d'Ivoire, The Federation of Saint Christopher and Nevis, Ghana, Guinea, Indonesia, Haiti, Mauritius, Philippines, Senegal, Seychelles, Sierra Leone, Sao Tome and Principe, Singapore and the State of Qatar.

Website for Visa application is here: https://irembo.gov.rw/home/citizen/all_services

Please note the following information for your visa application

Event Venue: Norrsken Kigali House

Address: KN 78 Street

Kigali, Rwanda

District: Nyarugenge

Sector: Nyarugenge

Cell: Kiyovu

Village: Indangamirwa

Vaccinations

You will need proof of a Yellow Fever vaccination. Visit the following site for updated information on vaccinations including COVID-19:

<https://www.rbc.gov.rw/index.php?id=745>

Connectivity

Rwanda is among the top three African countries in terms of internet connectivity, with an ever-growing fibre optic network. There is high speed 4G LTE wireless broadband in major cities. Local SIM cards are readily available. The main providers are MTN and Tigo.

Money

The Rwandan franc (Rwf) is the principal currency, although US dollars are widely accepted. Expect to pay for local services in cash, in Rwandan francs. The greater the amount, the more likely US dollars or other hard currencies are preferred. A growing number of places accept credit and debit cards (mainly Visa and MasterCard).

ATMs can be found in Kigali and nearly all major cities. Most bank ATMs accept MasterCard, Visa, American Express, Diners Club, Union Pay, and JCB. There are many ATMs accepting international cards at the airport. Nevertheless, plan to have extra cash at hand.

Cash can be exchanged at banks and private forex bureaux (bureau de change). Both are closed on Sundays and public holidays. It may be impossible to exchange travelers' cheques away from the capital. Western Union facilities are common.

Tipping is discretionary and appreciated. Cash is usually preferred. As a rough guide, tip professional guides and drivers US \$10 per day.

Plastic Ban

Please refrain from bringing plastic bags to Rwanda. Banned by law since 2008, any plastic bags in your luggage will be confiscated at the airport or other point of entry.

Health & Medical Insurance

Much of Rwanda lies at too high an elevation for malaria to be a major concern, but the disease is present and prophylactic drugs are recommended. Travelers should seek professional medical advice on taking anti-malarial medicines and take precautions to avoid mosquito bites, especially between dawn and dusk.

Travelers should ensure they are up to date with vaccinations, following the advice of their local healthcare provider, and should consider bringing a small first aid kit. A certificate of yellow-fever vaccination is required on entry.

It is advisable not to drink tap water. Bottled mineral water can be bought in all towns – make sure the seal is intact.

As a small country, medical help is rarely far away. For basic treatment most towns of any size have pharmacies, while larger towns have hospitals. King Faisal Hospital in Kigali is the most advanced in Rwanda.

In case of medical evacuation, Akagera Aviation operates a helicopter ambulance service within Rwanda in daylight hours, with one military paramedic on call. Please make sure you have adequate medical insurance.

Electrical

You will need to consider what to pack, to ensure you can use your personal electrical appliances safely. For Rwanda, there are two associated plug types, types C and J. Plug type C is the plug which has two round pins and plug type J is the plug which has three round pins. Rwanda operates on a 230V supply voltage and 50Hz.

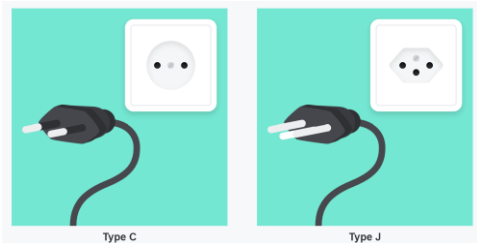

Weather

Fractionally south of the Equator and with much of the country lying at altitude, Rwanda enjoys an agreeable tropical highland climate. Temperatures vary considerably between locations but vary little from month to month.

Peak temperatures rarely exceed 30°C (86°F) in the daytime or drop below 15°C (59°F) at night. The average daily temperature in Kigali is 21°C (70°F).

There are two rainy seasons in a year, from mid-February to May and mid-September to mid-December. The dry season, from June to mid-September, sees light cloud cover and occasional light rainfall.

During the month of August, daily high temperatures are around 81°F, rarely falling below 77°F or exceeding 86°F. The highest daily average high temperature is 82°F during the month of August, while daily low temperatures are around 62°F, rarely falling below 58°F.

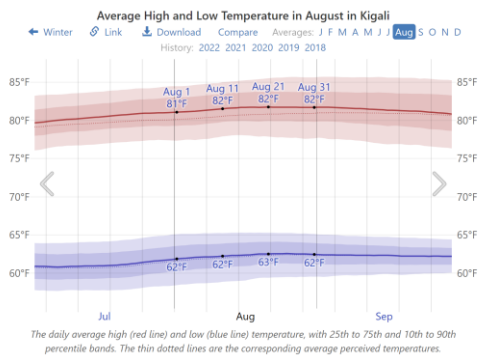

What to Wear

Dress codes are informal yet respectful. Men tend to wear trousers, but shorts are fine. Women will feel more comfortable in knee-length or longer clothing.

Daytime temperatures are generally warm, so bring lots of light clothing and think about sun protection, including a hat and sunglasses if outdoors. The evenings tend to be cool, and a light sweater appreciated.

In Volcanoes National Park and Nyungwe National Park, slightly heavier clothing is useful. A lightweight waterproof jacket may come in handy in the moist mountains. Avoid wearing blue in Akagera National Park, which attracts tse tse flies, and take sensible precautions against mosquitos and other bites. When tracking gorillas, wear sturdier clothing to protect against stinging nettles, and solid walking shoes. Consider bringing gardening or leather gloves as well as gaiters.

For those who wear contact lenses, cleaning fluid is not readily available, and dust or sun could prove an irritation, so it's best to bring a pair of glasses along for peace of mind.

Getting To and From the Airport and Around Kigali

Getting from and from Kigali airport is quite easy. The airport is conveniently located a short drive from most neighborhoods, and there is a range of options to choose from.

Taxi

Getting a taxi is quite straightforward. If you're getting a taxi from the airport, expect to haggle, as drivers will try charging a premium to unsuspecting tourists. Generally, taxis from the airport should cost 2500 RWF for the first kilometer, and 600 RWF per additional kilometer.

Hotel Transfer

Utilizing the hotel shuttle is a much easier option coming from the airport. Organize a transfer with your hotel or host in Kigali. While it's a little more expensive than a taxi, it's much more convenient.

Shuttle bus

Kigali Bus Service (KBS) provides hourly direct shuttles between Kigali Airport and the Union Trade Center (UTC) in the business district of central Kigali. The price of this shuttle is approximately 1000 RWF.

Rwanda has a well-surfaced road network linking the major towns, and the most convenient way to travel the country is by car. Smaller roads are frequently unsurfaced with varying conditions, especially during the rainy season.

Tour operators can arrange a vehicle with a driver, or a number of agencies rent out cars and 4x4s. Taxis operate in the larger towns. Travel insurance may not cover motorbike taxis, which are also common.

There are no rail services, and the most popular form of public transport is shared minibuses.

Bus

Bus stations in Kigali are known as 'taxi parks,' and you'll usually find one in every neighborhood. You can also catch a bus at a bus stop. There are many bus stops around the city.

In Kigali, buses operate a smart card system called Tap&Go. To board a bus, you'll need a "Tap & Go" card. These cards are available in every taxi park and most bus stops.

You can top up the cards in the following ways:

- Visit vendors at the taxi parks and bus stops
- Using MTN Mobile Money by dialing *182*2*5#
- Downloading the Tap&Go app on your phone. Use the following links to download the [Tap&Go](#) App.
 - Tap&Go Android: https://play.google.com/store/apps/details?id=com.qtsoftware.tapandgo&hl=en_US&gl=US&pli=1
 - Tap&Go iOS: <https://apps.apple.com/us/app/tap-go-rw/id1488291467>

Walking

Walking in Kigali is both pleasant and easy. The city's clean environment, extensive footpaths, and lack of traffic make walking easy and enjoyable. If you're downtown, check out the [Kigali CarFree Zone](#), which has been transformed specifically for pedestrians.

Even though Kigali is a very safe city, take precautions while walking, especially at night. Muggings and snatch-and-grab thefts from passing motorbike drivers have been reported. Don't walk with your phone out and try not to walk alone on quiet streets at night.

Taxi Apps

Kigali has two taxi and ride-hailing apps: Move and Yego Cabs. Both are available on Android devices and iPhones. Move is exclusively available to drivers of Volkswagen cars, so there are fewer drivers, but it's a much more comfortable ride. Yego offers motobike and cabs services via mobile app, you can also call 9191, a toll-free number, to order your ride. Using taxi apps in Kigali requires some patience. Many drivers still aren't used to using the apps, and will ring you to confirm your pickup and drop-off location. They may need help with directions, which can be challenging if you don't speak Kinyarwanda or French. And if you cancel a ride, they may not notice and show up anyway.

- Move: <https://move.rw/>
- Yego: <https://www.yegomoto.com/index.html#home>

[End of Document]